

Bendigo Health site map



Smoke Free

Bendigo Hospital is a SMOKE FREE site



Bendigo Health acknowledges the Traditional Custodians of the land and pay our respects to Elders past, present and emerging.

Bendigo Health is committed to ending family violence.



Bendigo Health is committed to LGTBIQA+ inclusive practice.

Transport and parking

Public Transport

Bendigo Hospital is a 20 minute walk from the Bendigo Railway Station. Bus stops at the Bendigo Health precinct are located on Barnard Street and Arnold Street. Visit [www.christiansbus.com.au/public\[1\]buses/bendigo-bus-timetable/](http://www.christiansbus.com.au/public[1]buses/bendigo-bus-timetable/) for timetables.

Taxi ranks

Taxis are available by calling 131 008 and can take you to the main entrances on the campus.

Cyclists

Bike racks are located near the Mercy Street and Drought Street entrances of the precinct.

Patient drop off

There is dedicated patient drop off to the CSC at Lucan Street and Mercy Street for the hospital.

Parking

On street car parking is available around the Bendigo Health precinct free of charge, however, time limits do apply in some areas. Accessible parking is available and is clearly signed. The multideck carpark can be accessed via Arnold or Lucan Streets. You can enter the Clinical Services Campus (CSC) from Level F of the multideck car park. There is also pedestrian access to the Stewart Street entrances of the CSC via Level C of the multideck car park.

Finding your way around the CSC











Finding your way around the CSC

The main public lifts in the CSC are accessed via the Lucan Street entry and Level F in the multi deck carpark. When attending appointments at Stewart Street, it is best to access the campus from the dedicated Stewart Street entrances, although there is a pedestrian pathway on Level 2 that links the Phillips and Hyett buildings. Each entry and department reception use a number sequence for identification. You may see something like this - Stewart Street Entry 2, Reception 3. This means enter at Stewart Street Entry 2 and approach Reception 3 for your appointment. There are wayfinding boards and directional signage at each entrance of the CSC.

©-CARD® Patents and trademarks used under license 6103616 zcard.com.au job No. 244011



Bendigo Clinical Services Campus floor map

-  Amenity
-  Amenity
-  Amenity
-  Amenity
-  Amenity
-  Reception
-  Public Corridor
-  Staff Corridor
-  Public Lifts / Stairs
-  Staff Lifts

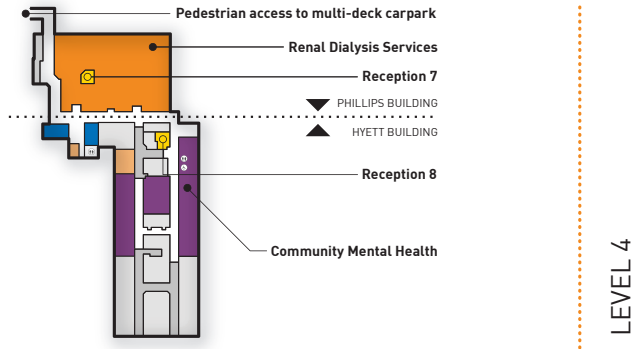

LEVEL 4

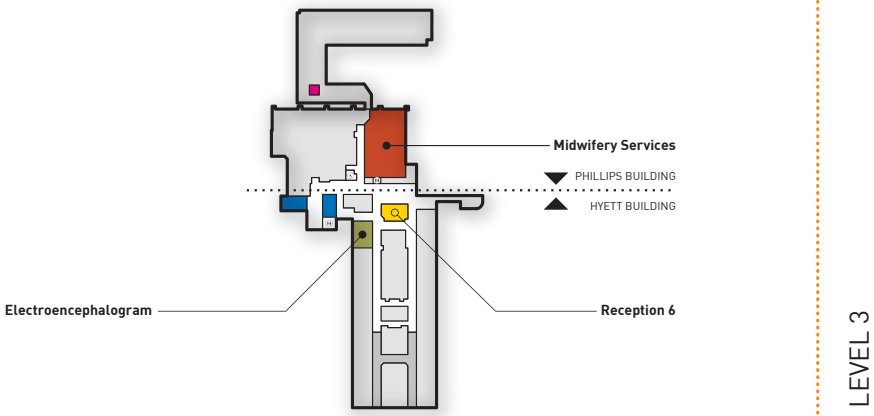

LEVEL 3

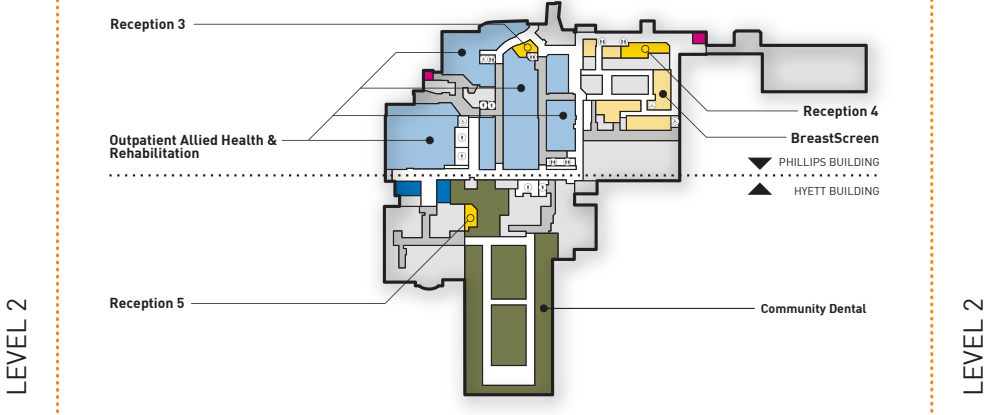

LEVEL 2

LEVEL 2

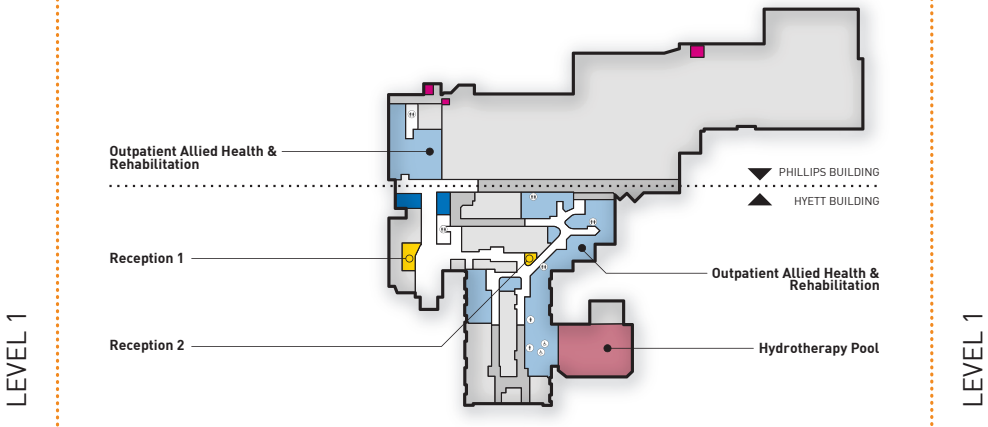

LEVEL 1

LEVEL 1

Services	Level	Services	Level	Services	Level
Outpatient Allied Health & Rehabilitation	1 & 2	BreastScreen	2	Renal Dialysis Services	4
Hydrotherapy Pool	1	Midwifery Services	3	Community Mental Health	4
Community Dental	2	Electroencephalogram	3		